

ECLIPSE AUTO SLIM DOORS Model TYPE 2-29 1/2"

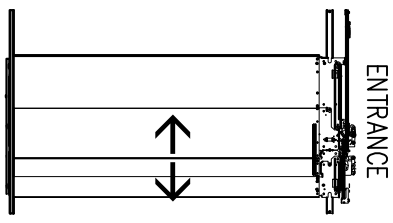

CHARACTERISTICS

- CAB DOOR TYPE: AUTO SLIM 2 SPEED DOORS
- ENTRANCE DOOR TYPE: AUTO SLIM 2 SPEED DOORS
- 2 SPEED DOORS FINISH: PAINT OR STAINLESS STEEL
- FULLY AUTOMATIC OPERATION TO OPEN THE DOORS UPON ARRIVAL AT THE LANDING
- LIGHTWEIGHT ALUMINUM SILL
- EMERGENCY BACK-UP BATTERY SYSTEM
- INFRARED DETECTION SYSTEM TO RETRACT DOORS BEFORE HITTING AN OBSTRUCTION

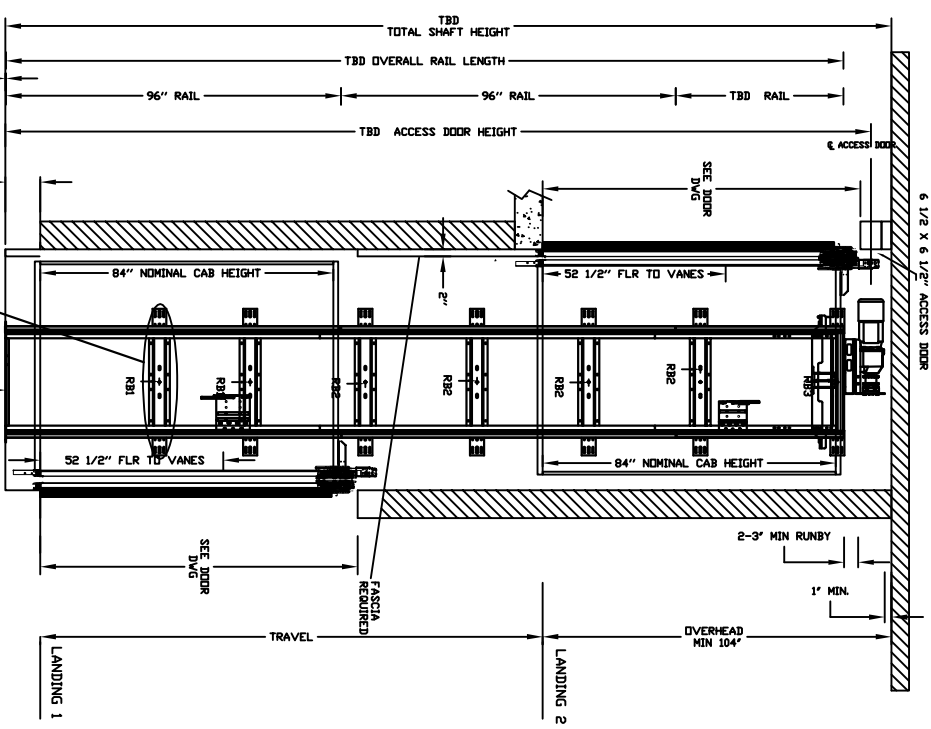
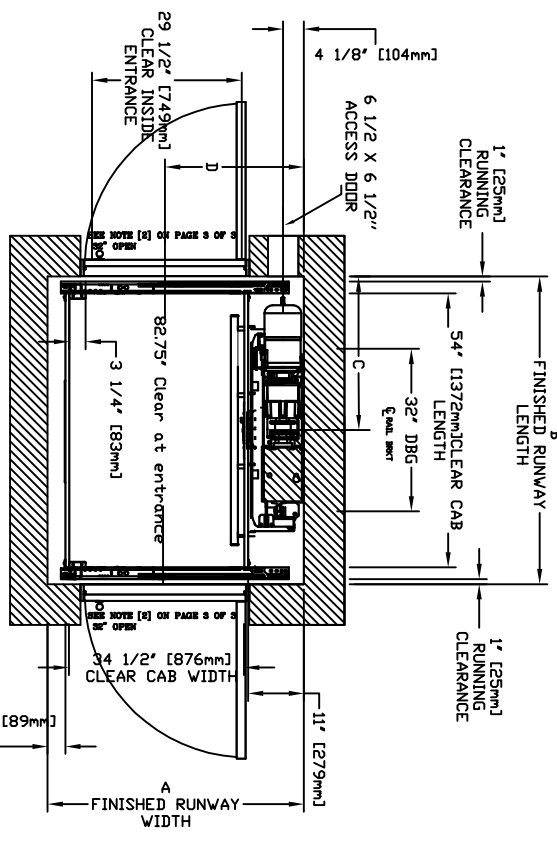

CLEAR INSIDE CAB WIDTH	CLEAR INSIDE CAB LENGTH	A FINISHED RUNWAY WIDTH		B FINISHED RUNWAY LENGTH		C RAIL CENTER LINE		D DOOR CENTER LINE			
		mm	Inches	mm	Inches	mm	Inches	mm	Inches		
876	34 1/2	1219	48	1283	50 1/2	1387	54 5/8	694	27 5/16	695	27 3/8
876	34 1/2	1372	54	1283	50 1/2	1540	60 5/8	770	30 5/16	695	27 3/8
876	34 1/2	1524	60	1283	50 1/2	1692	66 5/8	846	33 5/16	695	27 3/8

DOCUMENT REVISION 000, DATE: 02/28/17

RESIDENTIAL ELEVATOR ECLIPSE SLIMS DOORS TYPE 2-29 1/2

ALL INFORMATION IS SUBJECT TO CHANGE.
PLEASE REFERENCE OUR ON-LINE DRAWINGS AT
www.savaria.com FOR THE MOST RECENT UPDATES



THE INFORMATION DISCLOSED HEREIN IS THE EXCLUSIVE PROPERTY OF SAVARIA. ANY USE OR REPRODUCTION WITHOUT WRITTEN CONSENT IS PROHIBITED.

RAIL FORCES	
* R1	* R2
1382 kg [3044 lb]	882 kg [1944 lb]
1382 kg [3044 lb]	1124 kg [2479 lb]
RAIL WEIGHT: 180 lbs / ft	RAIL WEIGHT: 180 lbs / ft
PIT FORCE: R3	
PIT FLOOR TO SUPPORT LOAD (INCLUDES IMPACT) 2909 kg [6400 lbs]	

FINAL RAIL BRACKET	INTERMEDIATE RAIL BRACKET	BOTTOM RAIL BRACKET
RB3	RB2	RB1
BELOW THE MOTOR CONSULT YOUR REPRESENTATIVE FOR EXACT LOCATION	32" [813mm] INTERVALS AFTER 2nd BOTTOM BRACKET	39" [991mm] & 71" [1804mm] ABOVE PIT FLOOR

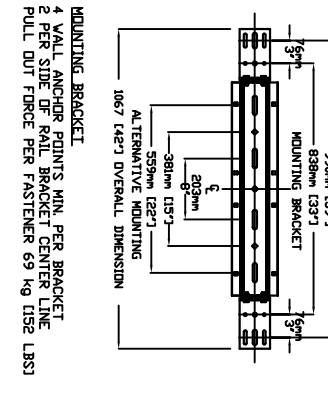

CANNOT HAVE HABITABLE SPACE BELOW PIT

LOAD BEARING WALL (SEE PLANNING GUIDE)

4 WALL ANCHOR POINTS MIN PER BRACKET
2 PER SIDE OF RAIL BRACKET CENTER LINE
PULL OUT FORCE PER FASTENER 69 kg [152 LBS]